

SAFETY CAUTION:

BEFORE SERVICING THIS CHASSIS, IT IS IMPORTANT THAT THE SERVICE TECHNICIAN READ AND FOLLOW THE "X-RAY RADIATION PRECAUTION," "SAFETY PRECAUTIONS" AND "PRODUCT SAFETY NOTICE" IN THE SERVICE MANUAL.

1. WAVEFORMS TAKEN USING SIGNAL FROM A STANDARD COLOR BAR GENERATOR.

2.  INDICATES WAVEFORM CHECK POINTS.

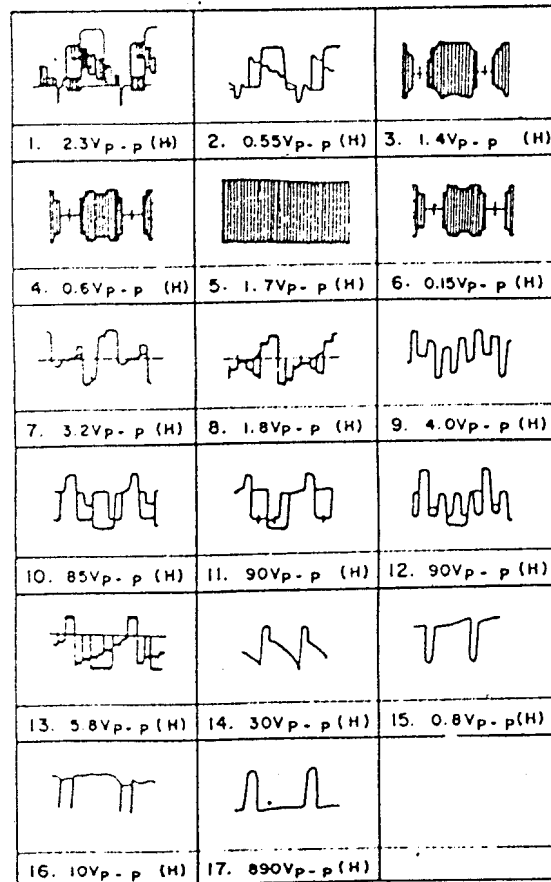

NOTES:

1. RESISTANCE VALUES ARE IN OHMS K=1,000, M=1,000,000
2. CAPACITANCE VALUES 1.0 AND ABOVE ARE IN pF, THOSE BELOW ARE IN uF EXCEPT AS INDICATED.
3. INDUCTOR VALUES IN uH EXCEPT AS INDICATED.
4. VOLTAGES ARE MEASURED FROM CHASSIS GROUND TO POINT INDICATED WITH A "VTVM" WHILE RECEIVING A COLOR BAR SIGNAL WITH ALL CONTROLS SET TO THE MAXIMUM POSITION. (FOR A NOMINAL LINE VOLTAGE AC 110-260V, 50HZ).
5. SINCE THE CIRCUIT DIAGRAM IS A STANDARD ONE, THE CIRCUIT AND CIRCUIT CONSTANTS MAY BE SUBJECT TO CHANGE FOR IMPROVEMENT WITHOUT ANY NOTICE.

PRODUCT SAFETY NOTE:

SHADED COMPONENTS HAVE SPECIAL CHARACTERISTICS IMPORTANT TO SAFETY AND SHOULD BE REPLACED ONLY WITH TYPES IDENTICAL TO THOSE IN THE ORIGINAL OR SPECIFIED IN THE PARTS LIST.

DON'T DEGRADE THE SAFETY OF THE SET THROUGH IMPROPER SERVICING..

LOCAT- ION NO	14.16 INCH	20 INCH	LOCAT- ION NO	14.16 INCH	20 INCH
Q402	2SD1554	2SD1555			
T301	SPC462550	SPC462548	R241	150K OHM	120K OHM
T402	DCF1551P	DCF2052P	R431	2W 3 OHM (F)	2W 1 OHM (F)
C325	0.30 200V	0.33 200V			
C420	3000 1.6KV	3900 1.6KV	CRT	14" 370 EGB22	510 RJ8 22
				16" 420 EGB22A	

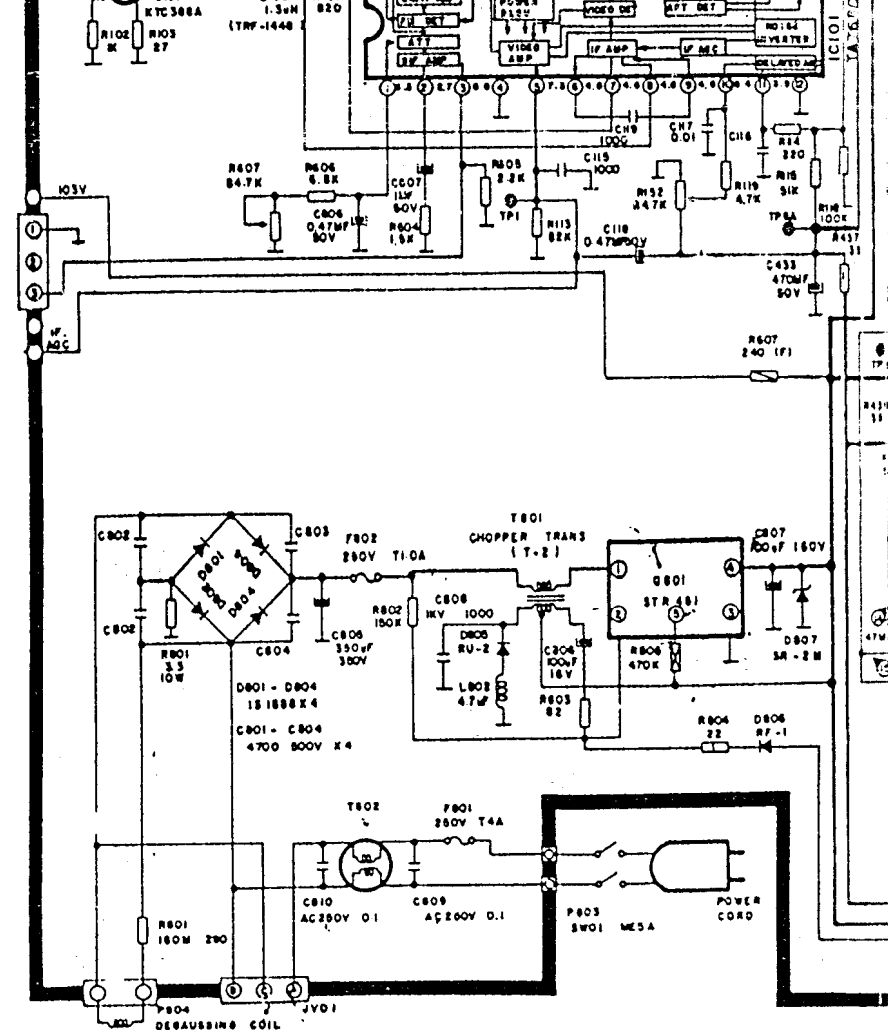

www.tvservice.org - Free schematic diagrams

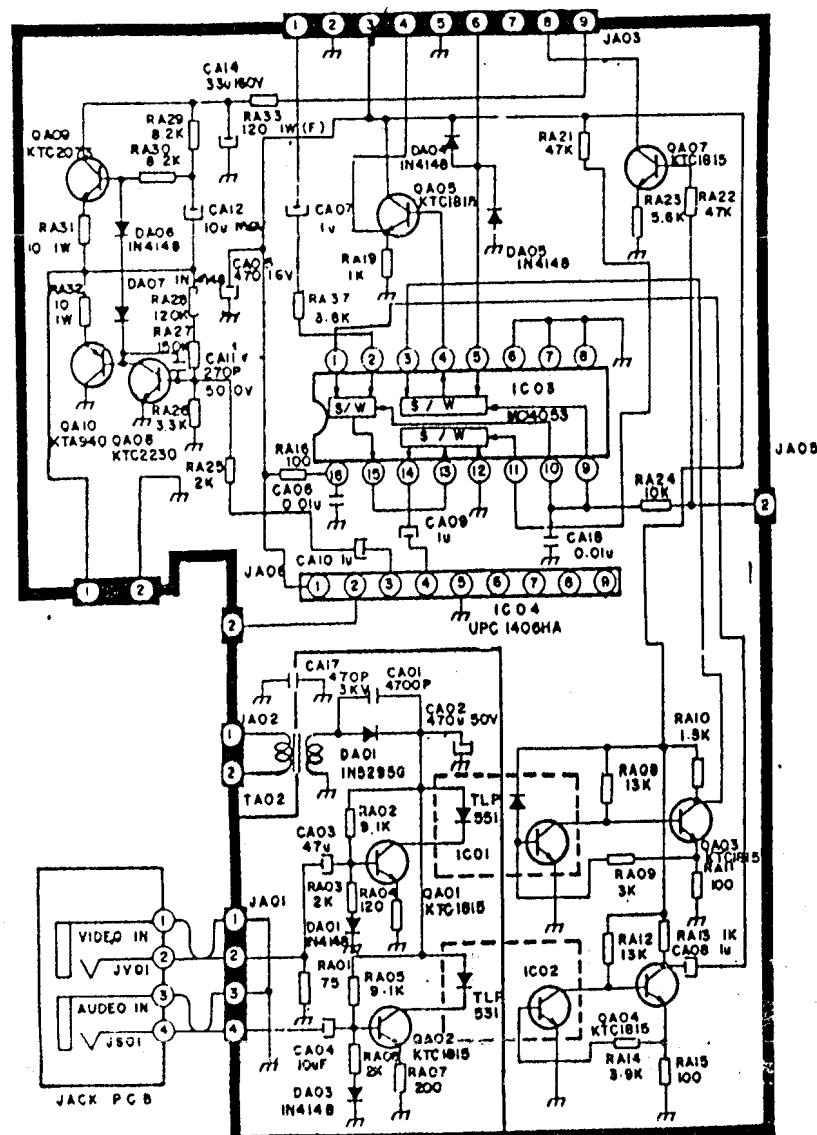

NOTES:

1. RESISTANCE VALUES ARE IN OHMS K=1000, M=1,000,000
2. CAPACITANCE VALUES 1.0 AND ABOVE ARE IN pF, THOSE BELOW ARE IN μF EXCEPT AS INDICATED.
3. INDUCTOR VALUES IN μH EXCEPT AS INDICATED.
4. VOLTAGES ARE MEASURED FROM CHASSIS GROUND TO POINT INDICATED WITH A "VTVM" WHILE RECEIVING A COLOR BAR SIGNAL WITH ALL CONTROLS SET TO THE MAXIMUM POSITION.

SAFETY CAUTION:

BEFORE SERVICING THIS CHASSIS, IT IS IMPORTANT THAT THE SERVICE TECHNICIAN READ AND FOLLOW THE "X-RAY RADIATION PRECAUTION," "SAFETY PRECAUTIONS" AND "PRODUCT SAFETY NOTICE" IN THE SERVICE MANUAL.

1. WAVEFORMS TAKEN USING SIGNAL FROM A STANDARD

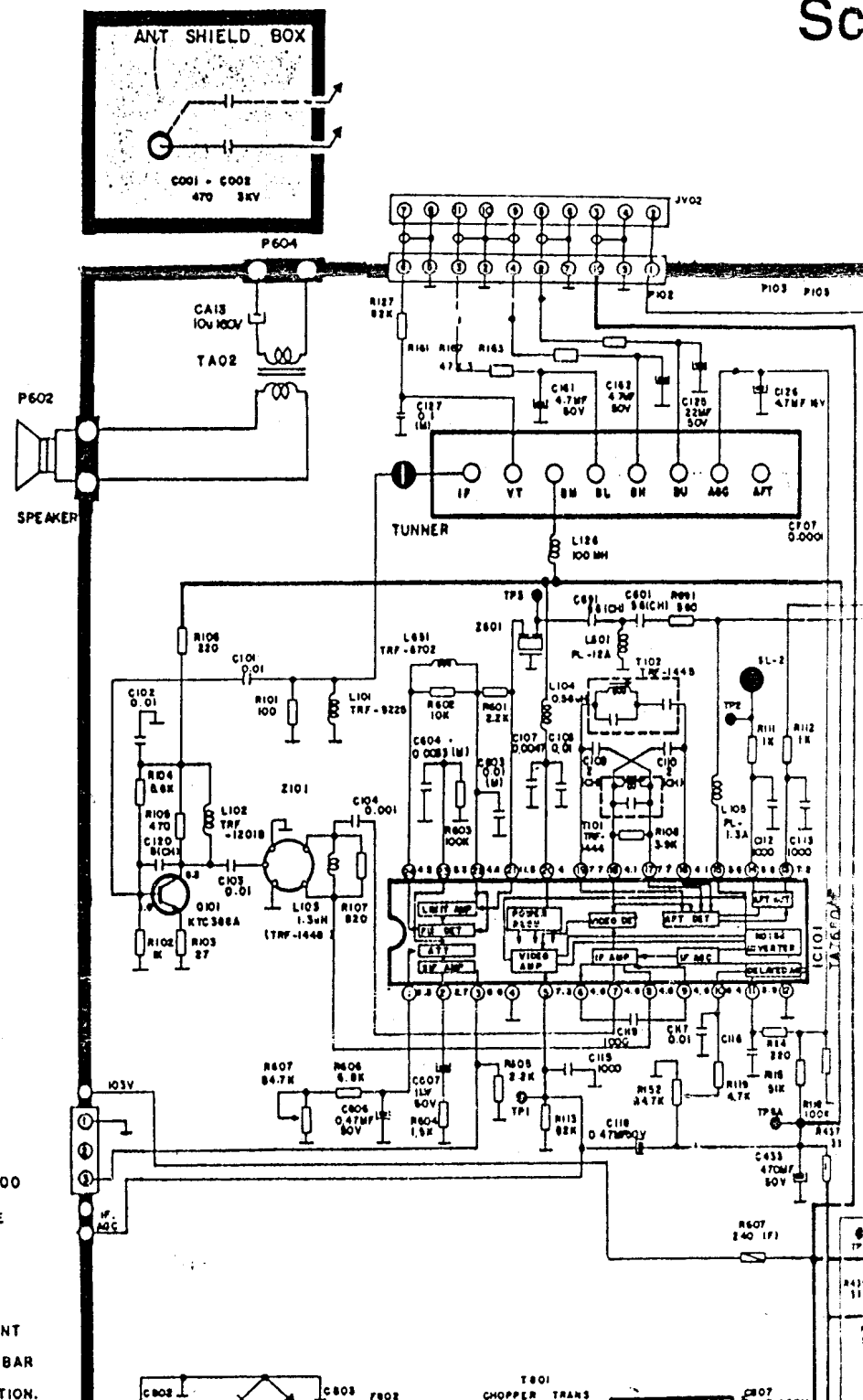

TEC 5173 VR

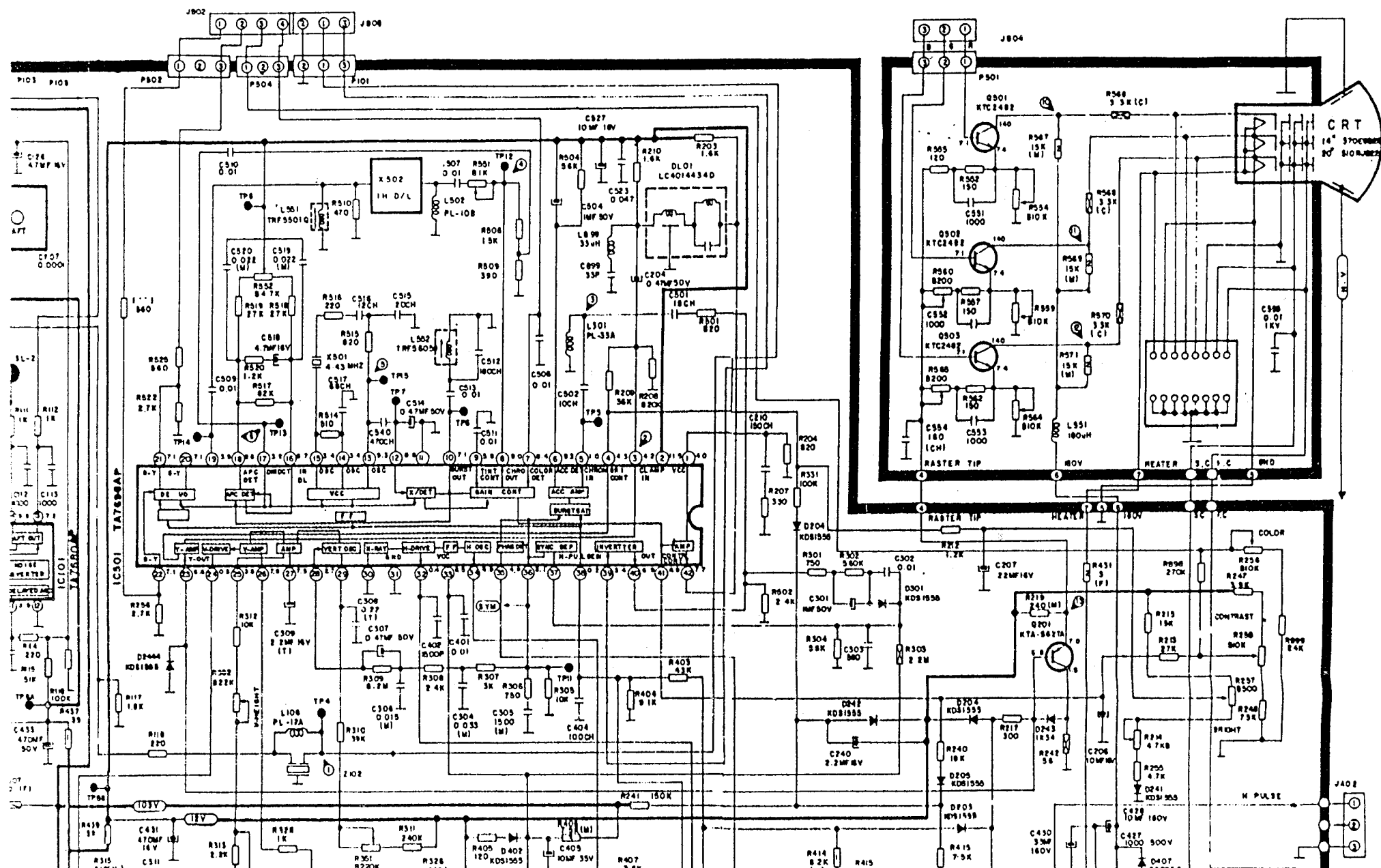

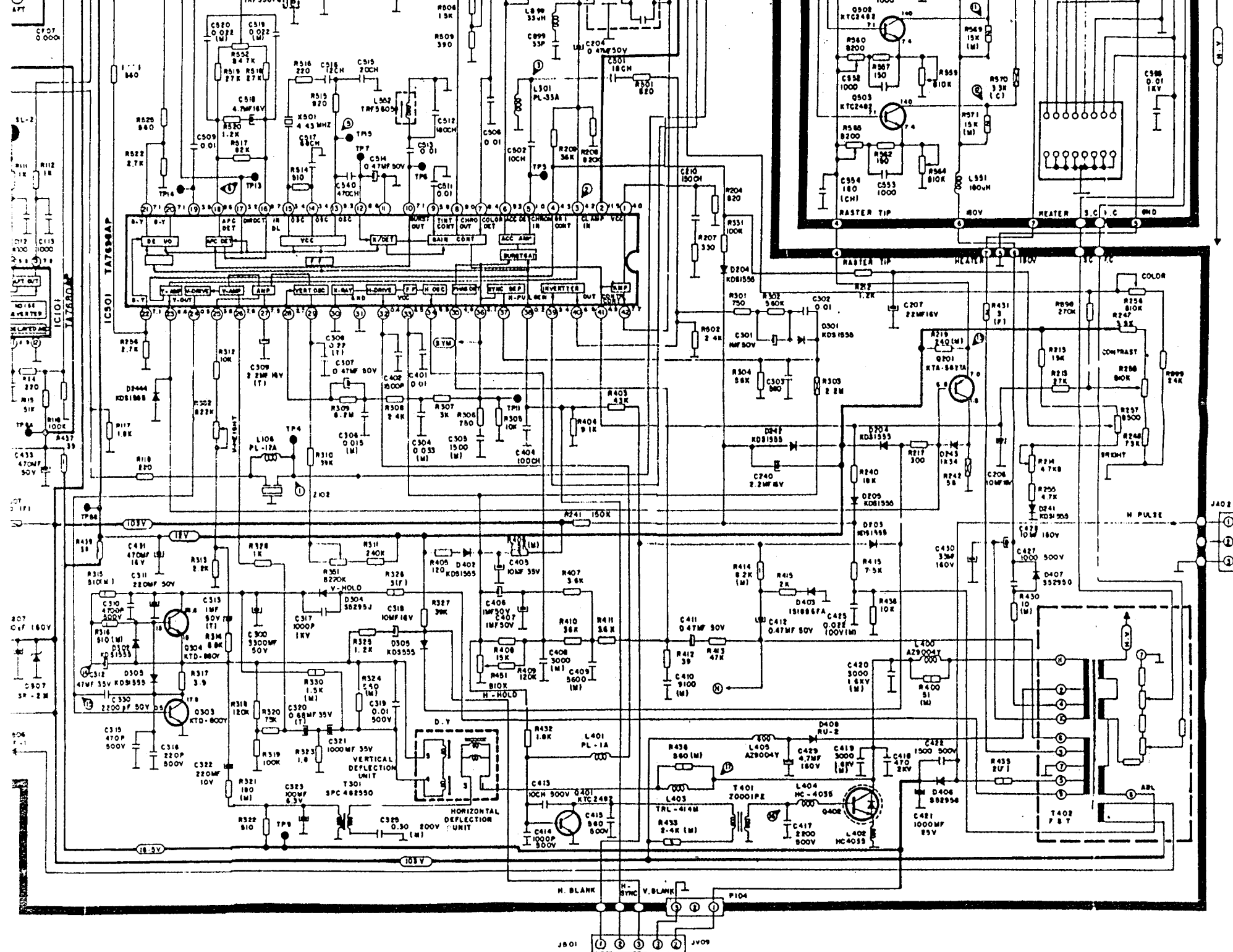

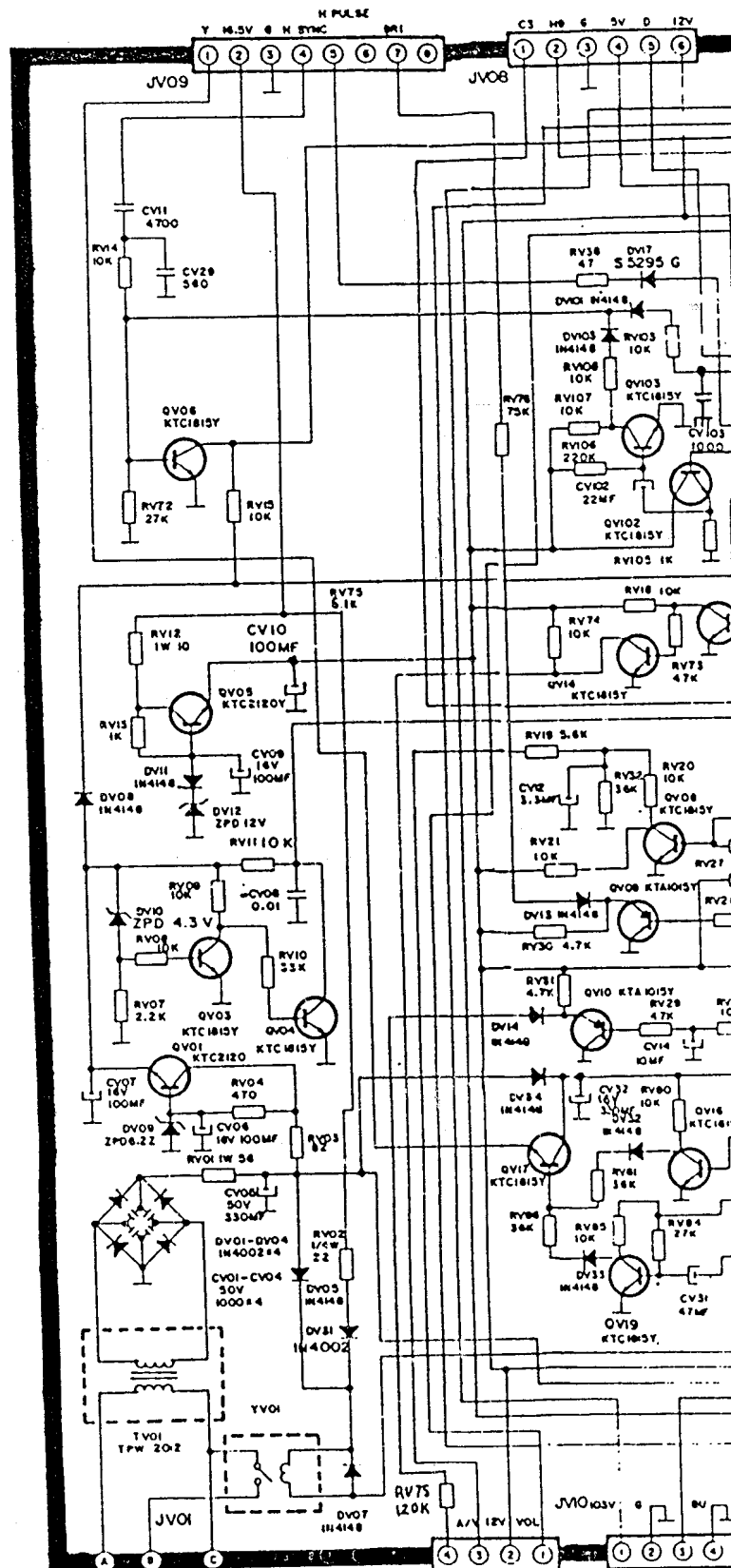
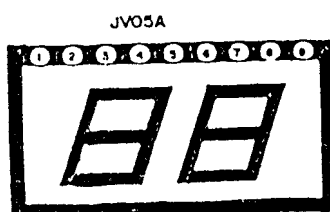
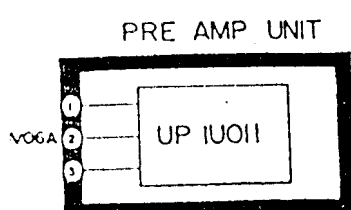
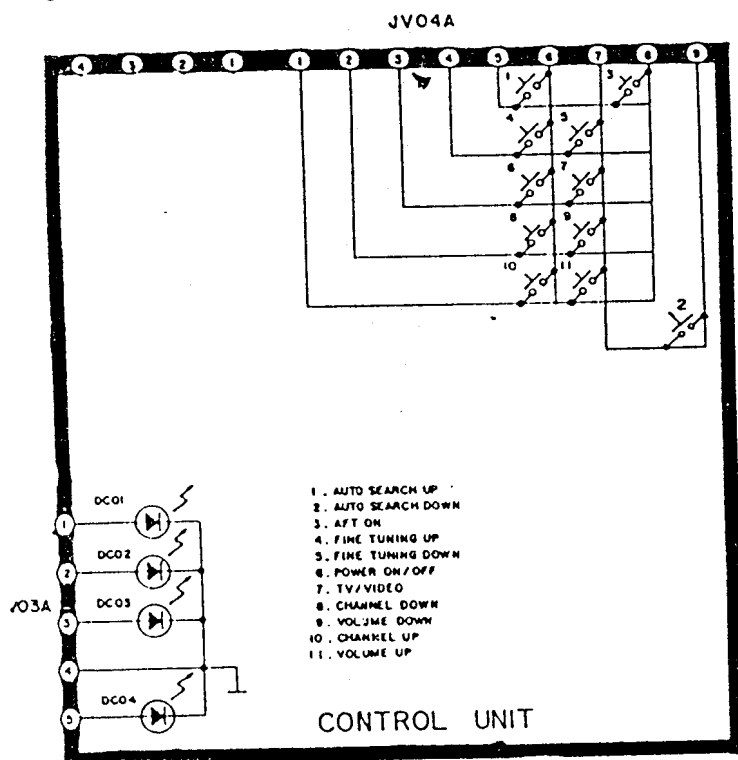
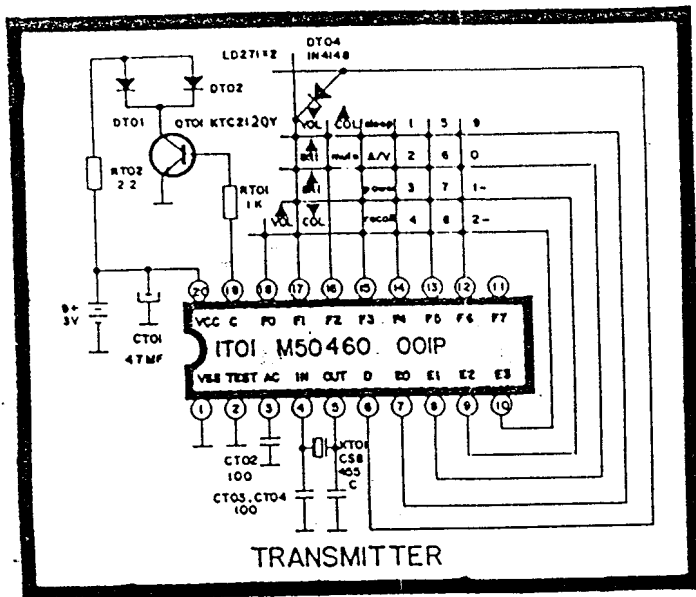

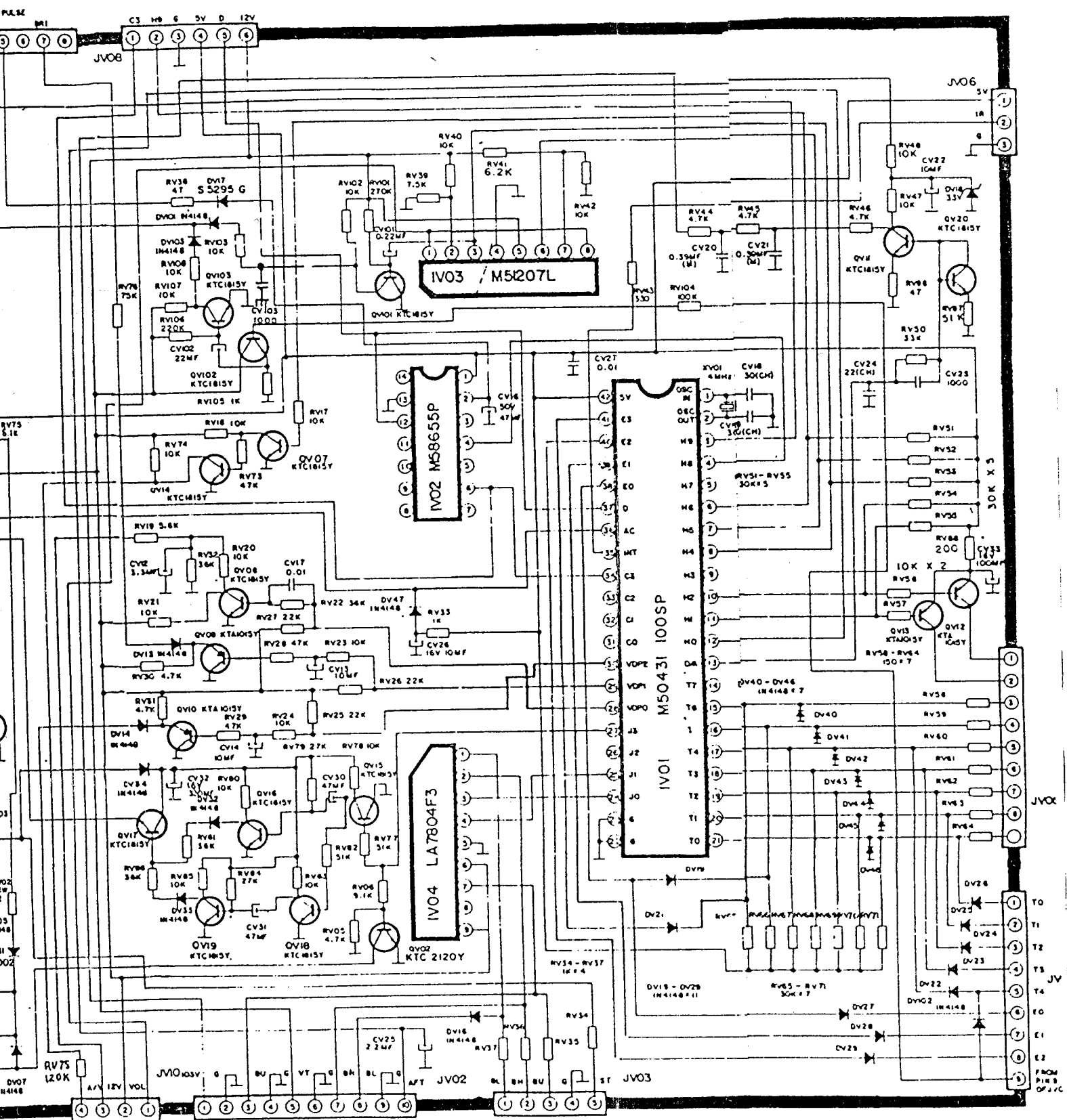

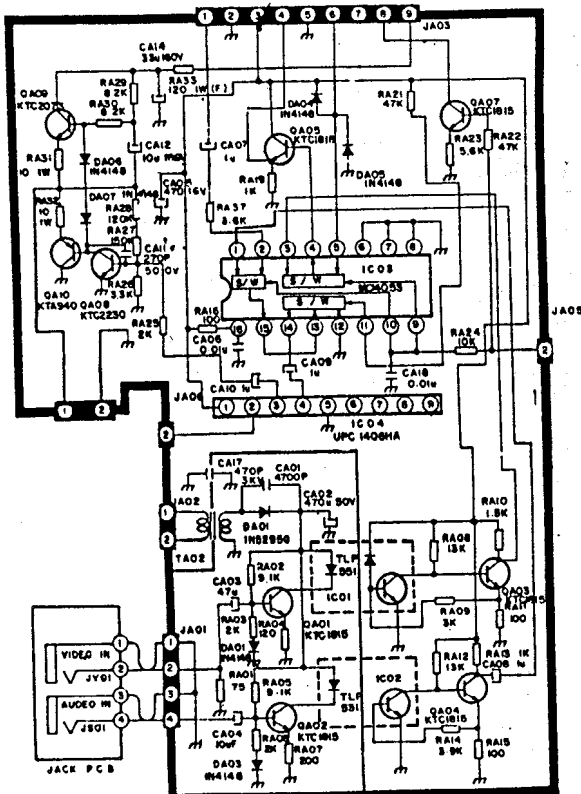

NOTES:

1. RESISTANCE VALUES ARE IN OHMS K=1000, M=1,000,000
2. CAPACITANCE VALUES 1.0 AND ABOVE ARE IN μF , THOSE BELOW ARE IN nF EXCEPT AS INDICATED.
3. INDUCTOR VALUES IN μH EXCEPT AS INDICATED.
4. VOLTAGES ARE MEASURED FROM CHASSIS GROUND TO POINT INDICATED WITH A "VTVM" WHILE RECEIVING A COLOR BAR SIGNAL WITH ALL CONTROLS SET TO THE MAXIMUM POSITION. (FOR A NOMINAL LINE VOLTAGE AC 110-280V, 50/60HZ).
5. SINCE THE CIRCUIT DIAGRAM IS A STANDARD ONE, THE CIRCUIT AND CIRCUIT CONSTANTS MAY BE SUBJECT TO CHANGE FOR IMPROVEMENT WITHOUT ANY NOTICE.

PRODUCT SAFETY NOTE:

SHADED COMPONENTS HAVE SPECIAL CHARACTERISTICS IMPORTANT TO SAFETY AND SHOULD BE REPLACED ONLY WITH TYPES IDENTICAL TO THOSE IN THE ORIGINAL OR SPECIFIED IN THE PARTS LIST.

DON'T DEGRADE THE SAFETY OF THE SET THROUGH IMPROPER SERVICING.

LOCATION NO.	14 INCH	20 INCH	LOCATION NO.	14 INCH	20 INCH
Q402	2SD1554	2SD1555	R241	150K OHM	120K OHM
T301	SPC462500	SPC462548	R431	2W 5 OHM (F)	2W 1 OHM (F)
T408	DCF 1551P	DCF 2082P	C385	0.20 200V	0.33 200V
C385	0.20 200V	0.33 200V	C420	3000 14KV	2900 14KV
C420	3000 14KV	2900 14KV	CRT	14" 370 E88 28	510 R 28 22
				18" 420 E 422A	

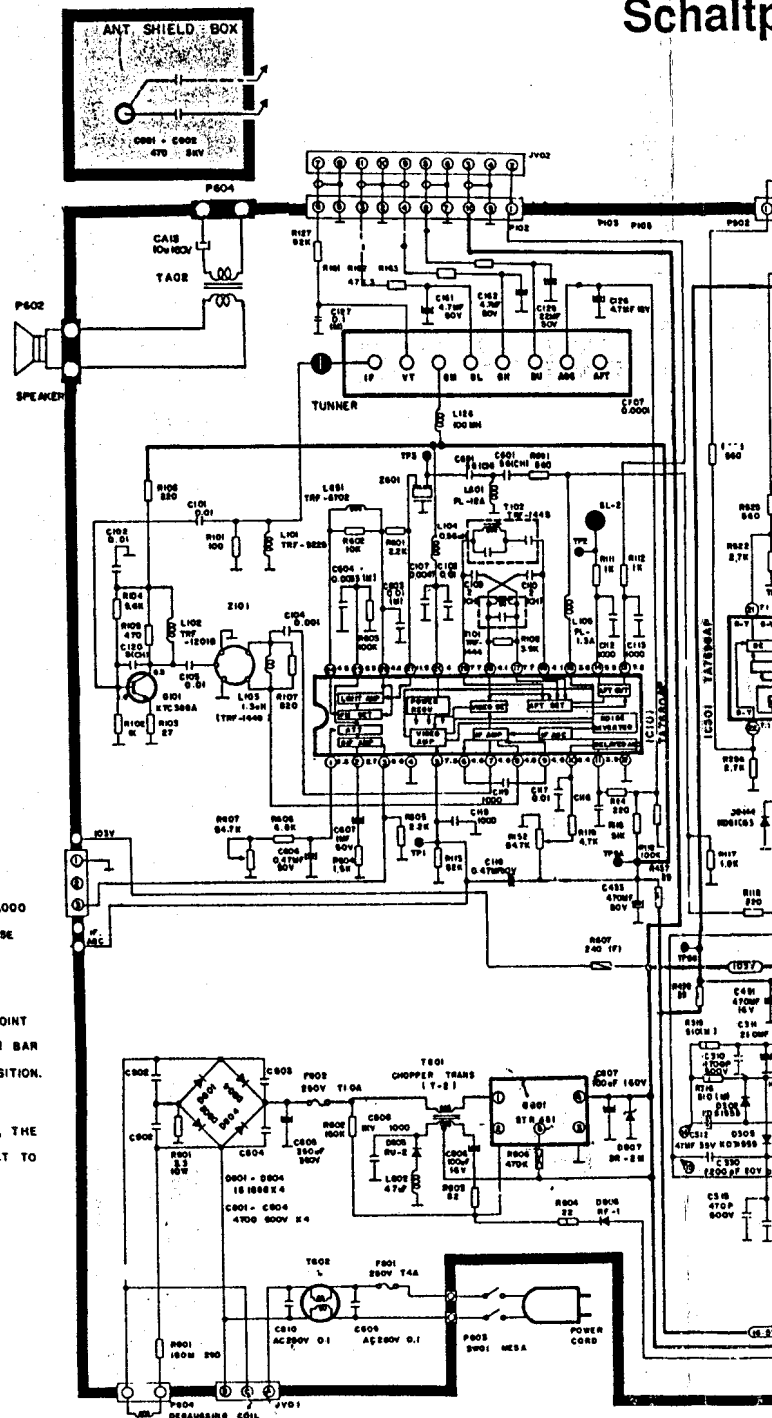

CAUTION:

(SERVICING THIS CHASSIS, IT IS IMPORTANT THAT THE TECHNICIAN READ AND FOLLOW THE RADIATION PRECAUTION, "SAFETY PRECAUTIONS" MUST SAFETY NOTICE" IN THE SERVICE

FORMS TAKEN USING SIGNAL FROM A STANDARD BAR GENERATOR.

INDICATES WAVEFORM CHECK POINTS.

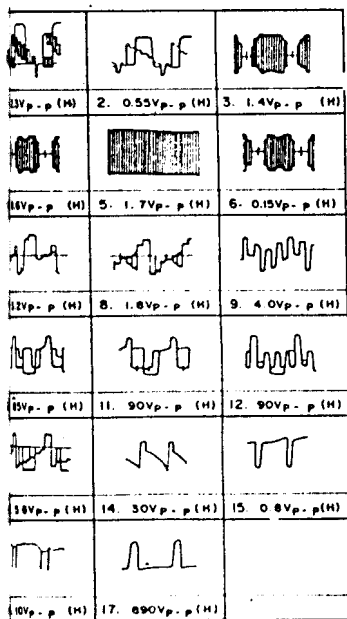

TEC 5173 VR

